

1 2 3 4 5 6 7 8

A

B

C

D

A

B

C

D

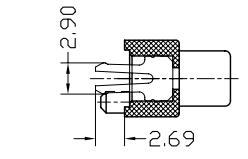

SECT C-C

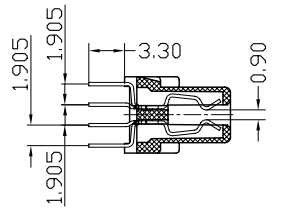

SECT B-B

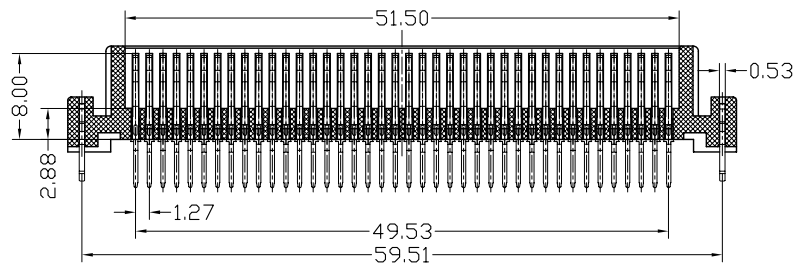
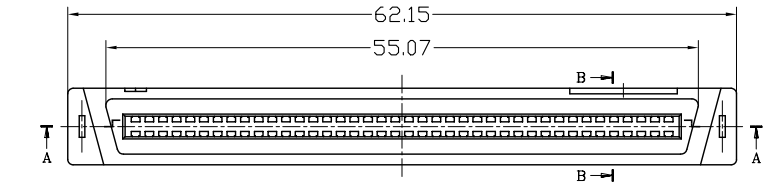

SECT A-A

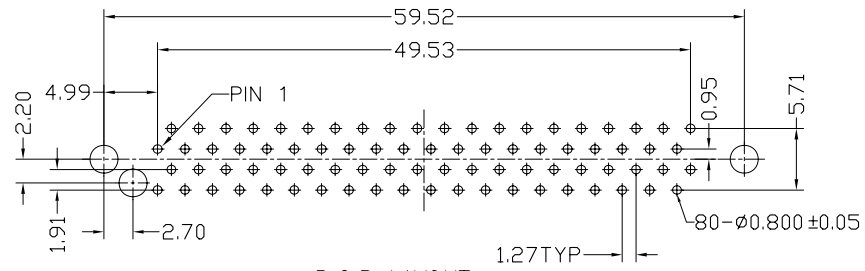
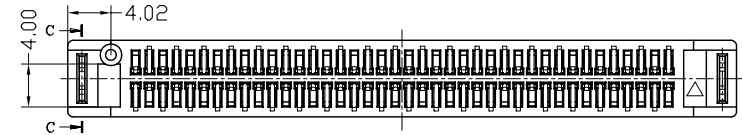

P.C.B LAYOUT
TOP VIEW

Notes:

***Material**

Body : NYLON66+30%G.F or PBT+30%G.F,
UL 94V-0 Rated.

Color: Black

Contacts : Phosphor Bronze

Plating: Gold plating over Nickel on contact
area; Tin plating on Solder Tail.

***Mechanical:**

Insertion Force: 1.15N max per contact pair;
Withdrawal Force: 0.15N min per contact pair;
Contact Retention Force: 4.9N min per contact;

***Electrical Specification**

Contact Resistance : 35 Milliohms Max.
Current Resistance : 1. Ampere
Insulation Resistance : 500 Megohms Min, At 500V AC.
Operating Temperature : -55°c to +105°c

***How to order:**

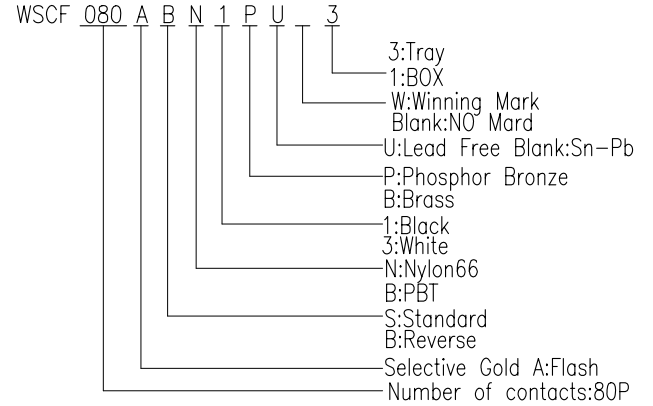

REV		Units		Drawing By		Date	
		mm	Scale				
		Tolerance Unless Otherwise Specified		Reviewed By		Date	
		.X	~ ±0.38	Approval By		Date	
		.XX	~ ±0.25			Date	
		.XXX	~ ±0.20			Sheet	1 of 1
		Angle	~ ± 3°			Third Angle Projection	
						Title	
						SCSI 2D SUB Female	
						Strip Form Pin 80P (Reverse)	
						Drawing No.	REV

1 2 3 4 5 6 7 8