

REV.	ECN.NO.	DATE
A	RELEASED	02/13/07

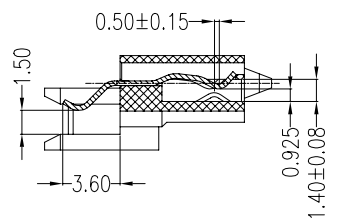
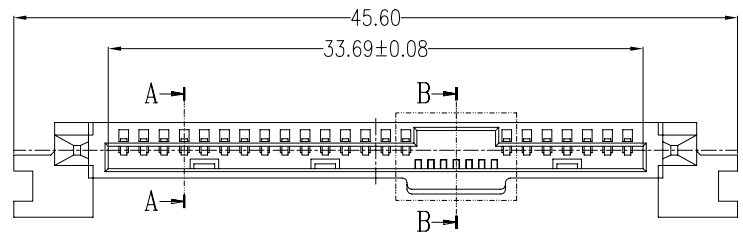
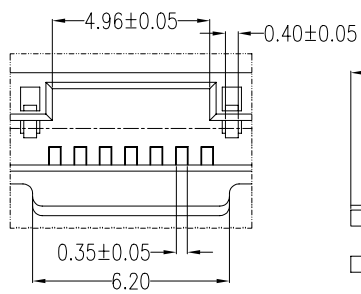

SECTION A-A

NOTES:

***Material**

Housing: LCP, UL 94V-0 rated, Color: Black;
 Contact: Phosphor Bronze;
 Plating: Gold plating over Nickel on contact area; Tin plating on solder tail.

***Mechanical**

Insertion Force: 45N max.
 Withdrawal Force: 10N min.
 Durability: 500 cycles

***Electrical Specification**

Current Rating: 1 Ampere per contact;
 Contact Resistance: 30 Milliohms max.
 Insulation Resistance: 1000 megohms min.
 Dielectric Withstanding Voltage: 500 V AC.

***Environmental**

Operating Temperature: 0°C to +55°C

***How to order**

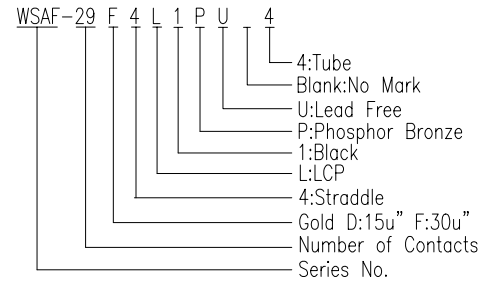

VIEW O
SCALE 2:1

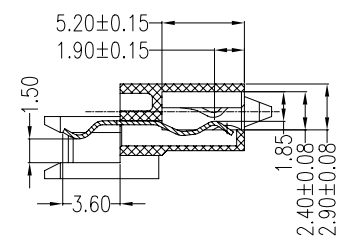
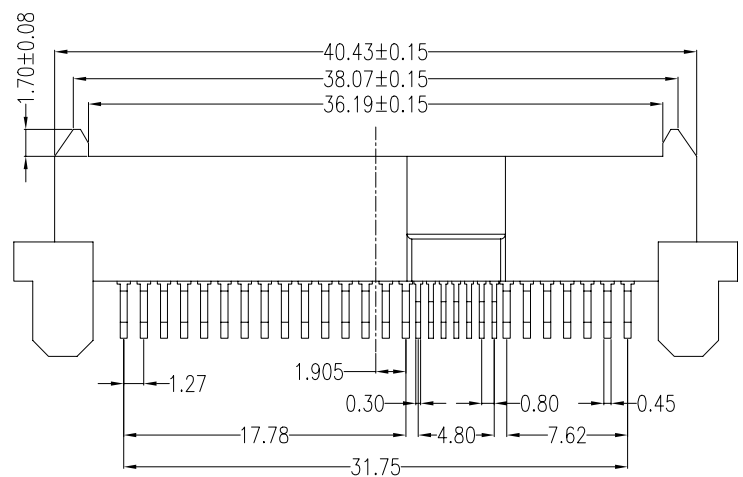
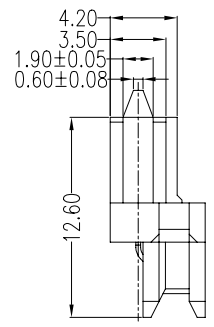

SECTION B-B

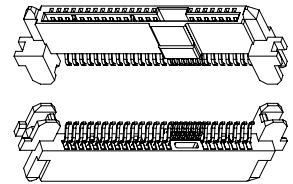

Product 3D Dwg

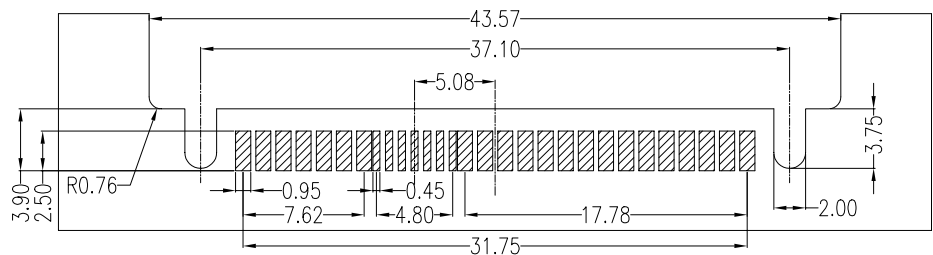
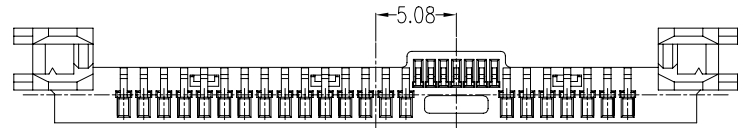

PCB LAYOUT

REV	Units		mm	Scale	2:1	Drawing By	Data		
	Tolerance Unless					ANDY	02/13/07	Date	02/13/07
	Otherwise Specified					Roger	02/14/07	Sheet	1 of 1
	.X	~	±0.38			Approval By	Data	Third Angle Projection	Title
	.XX	~	±0.25			Richard	02/14/07		SAS 29P Straddle Female CRT
	.XXX	~	±0.20					Drawing No.	WSAF-29PS-AN-N082
	Angle	~	± 3°					REV	A